

50 mm SeaRox FM 6040 between stiffeners and
 30 mm SeaRox FB/FM 6050 or
 35 mm SeaRox FB/FM 6040 over the stiffeners

3 mm steel pin
 with washer

Fire side

* Dimensions may vary depending on structural design and size of insulation material. All measurements in mm



TECHNICAL INSULATION



Subject: A-60 Steel Deck:
 Plate: SeaRox FM 6040
 Stiffener: SeaRox FB/FM 6050 or SeaRox FB/FM 6040

Date: 2023/08/10

Designer: DG

Drawing No. 800-1

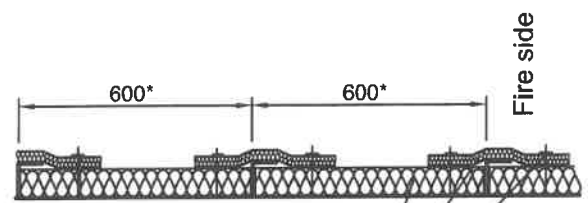
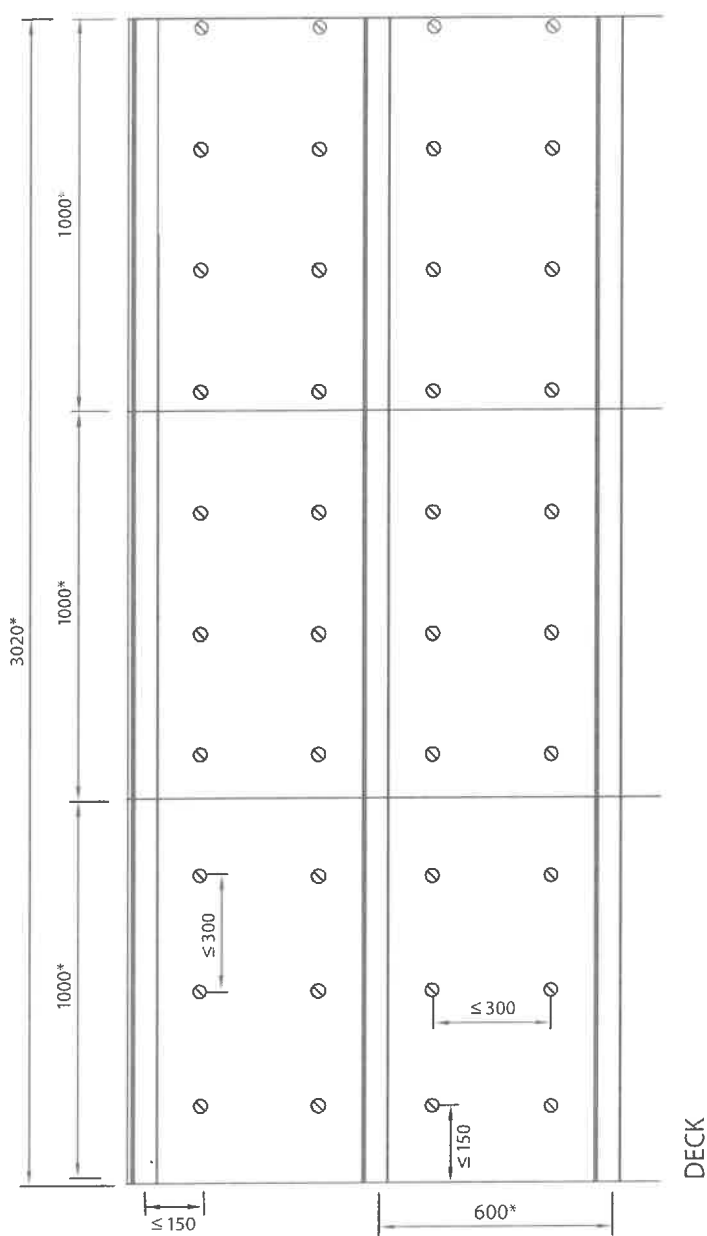

50 mm SeaRox FM 6040 between stiffeners and
 30 mm SeaRox FB/FM 6050 or
 35 mm SeaRox FB/FM 6040 over the stiffeners

3 mm steel pin
 with washer

* Dimensions may vary depending on structural design and size of insulation material. All measurements in mm



TECHNICAL INSULATION



Subject: A-60 Steel Deck:
 Plate: SeaRox FM 6040
 Stiffener: SeaRox FB/FM 6050 or SeaRox FB/FM 6040

Date: 2023/08/10 Designer: DG Drawing No. 800-2

TOP VIEW

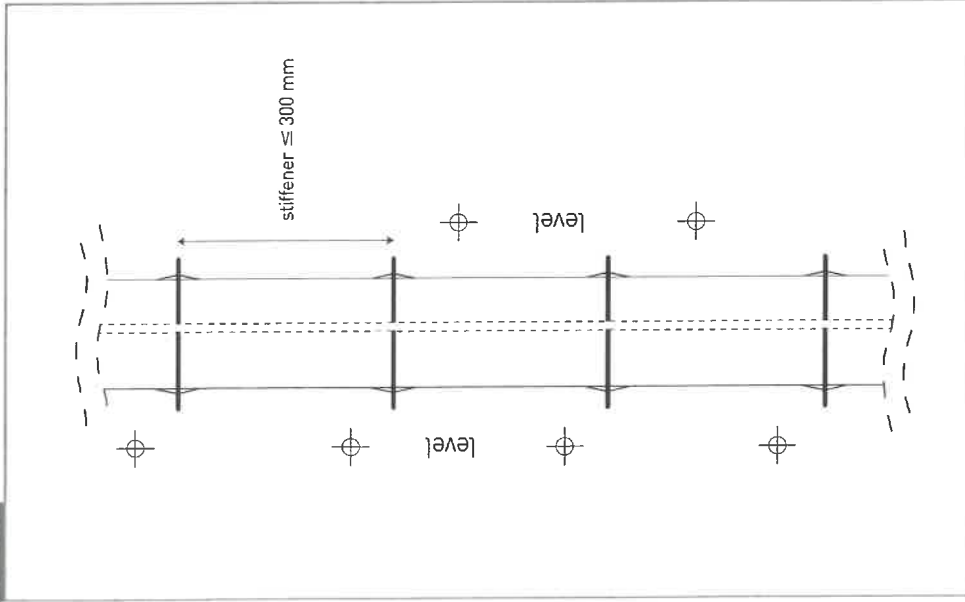

SECTION A

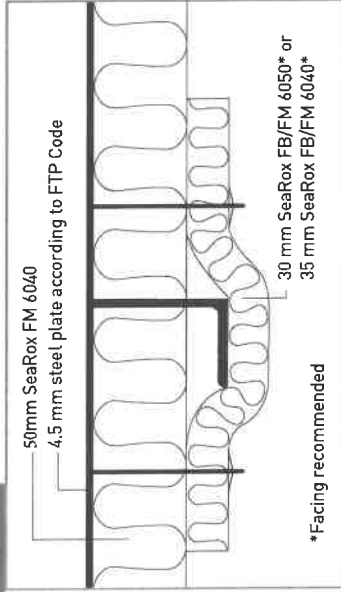

SECTION B

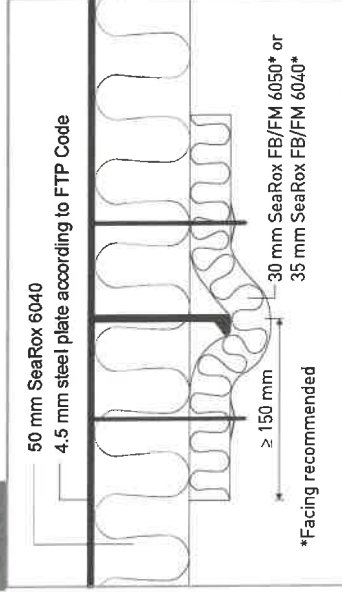

SECTION C

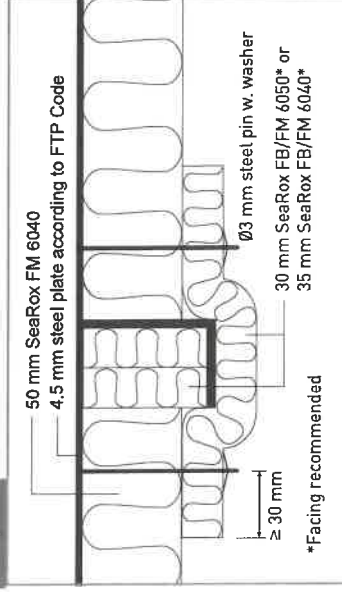

SECTION D

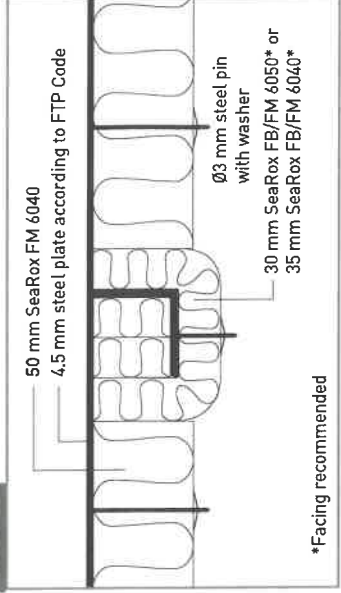

SECTION E

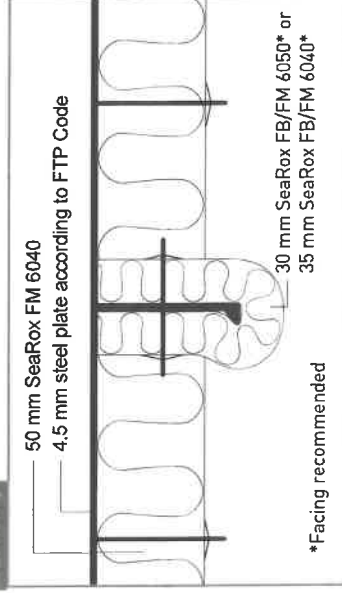

SECTION F

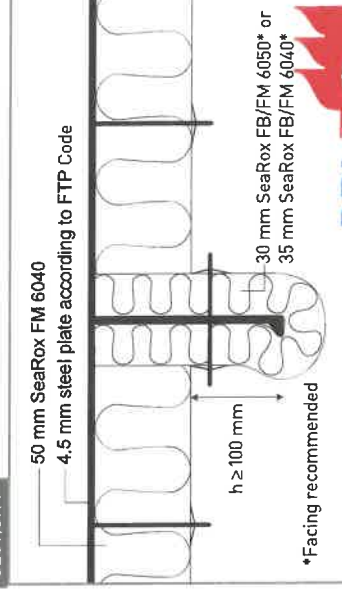

Handwritten signature

Subject: A-60 Steel Deck:
Plate: SeaRox FM 6040
Stiffener: SeaRox FB/FM 6050 or SeaRox FB/FM 6040

Date: 2023/08/10

Designer: DG

Drawing No. 800-3



TECHNICAL INSULATION

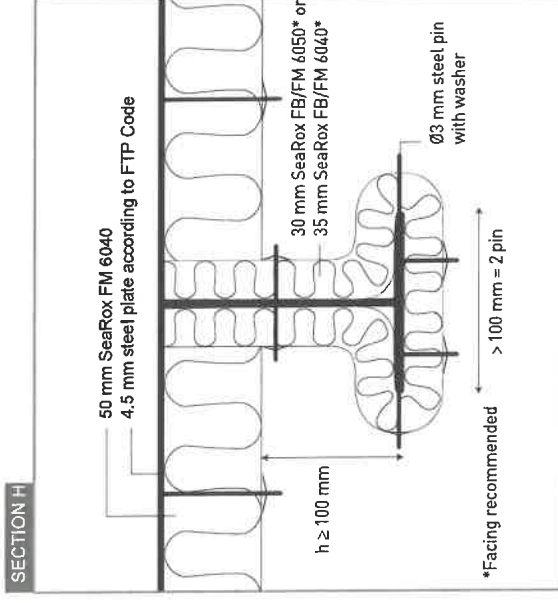
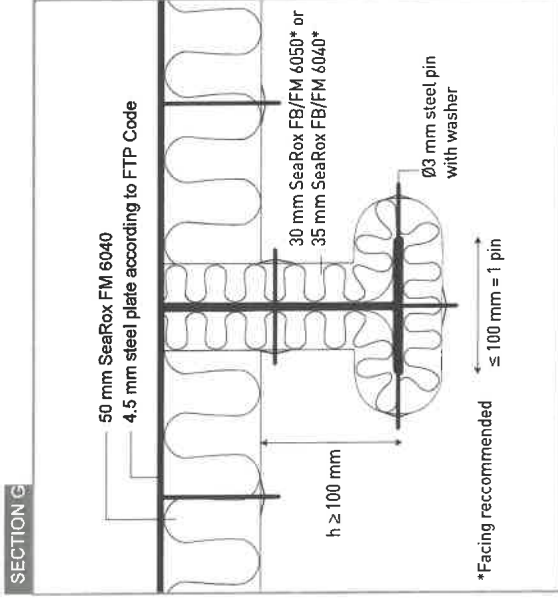
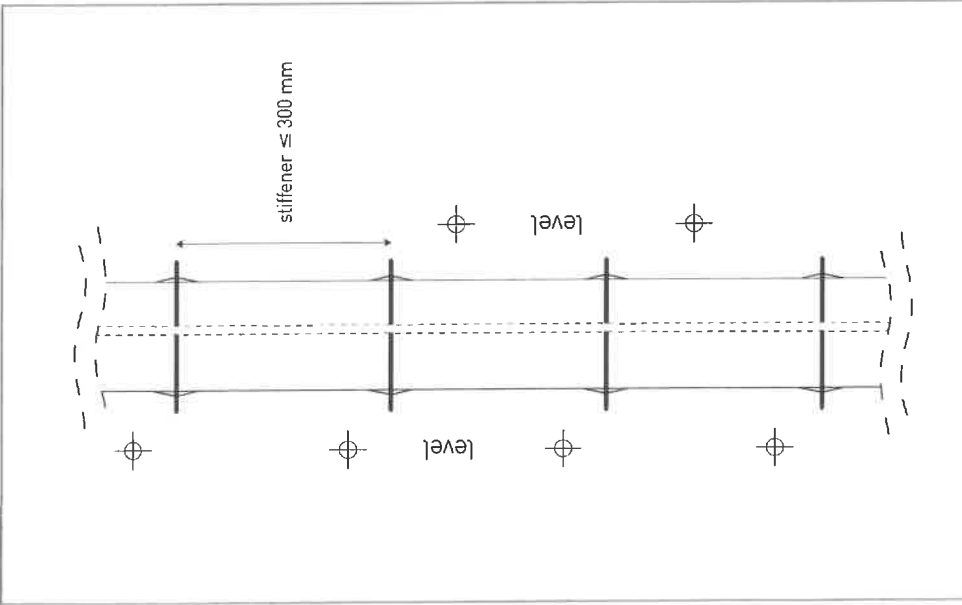

Subject: A-60 Steel Deck:
Plate: SeaRox FM 6040
Stiffener: SeaRox FB/FM 6050 or SeaRox FB/FM 6040

