

SeaRox® facings

ROCKWOOL Technical Insulation offers a wide range of facings for SeaRox insulation products.

Reinforced aluminium foil (ALU)

Glass fibre scrim reinforced aluminium foil, total approx. 85 g/m².
 This surface is mainly used as a vapour barrier or to ensure a dust-free surface. Used for a maximum service temperature of 80°C.
 Note: The aluminium foil on wired mats is perforated in the stitching process and so cannot be used as a water vapour barrier.

Glass cloth white (GW200)

White woven glass cloth, approx. 210 g/m².
 This facing functions as a surface, removing the need for additional metal cladding. The glass cloth creates an attractive, impact-resistant, dust-free surface.

Glass cloth white (GW400)

Heavy, white woven glass cloth, approx. 450 g/m².
 The facing functions as a surface, eliminating the need for extra metal cladding. The glass cloth creates an attractive, impact-resistant, dust-free surface.

Aluminium foil laminated with glass cloth (ALU-G)

Aluminium foil laminated with white glass cloth on the underside, approx. 275 g/m².
 This facing has a smooth and shiny surface. It is heavy-duty and easy to clean. The laminated aluminium foil serves as a water vapour barrier.

White glass cloth laminated with aluminium foil (GW-A)

White glass cloth laminated with aluminium foil on the underside, approx. 275 g/m².
 This facing creates a strong, impact-resistant, dust-free surface. The facing combines the water vapour barrier properties of aluminium foil with the mechanical resistance and attractive appearance of glass cloth.

Glass tissue neutral (TN)

Glass tissue neutral (TN) is a white/neutral glass tissue, approx. 60 g/m².
 This glass tissue provides dust encapsulation, while the neutral/translucent look creates brightness.

Glass tissue black (TB)

Glass tissue black (TB) is a black glass tissue, approx. 60 g/m².
 This glass tissue provides dust encapsulation and a low-key background. The black tissue is often used in ventilation shafts or behind a perforated plate.



0575



0097

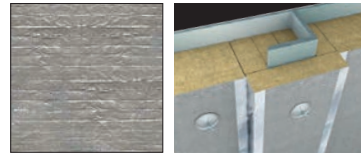

Reinforced aluminium foil (ALU)

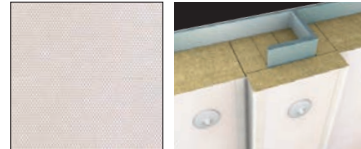

Glass cloth white (GW200)



Glass cloth white (GW400)

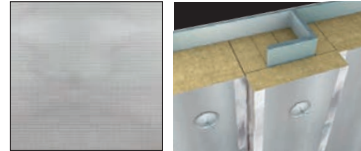

Alu foil laminated with glass cloth (ALU-G)



White glass cloth with aluminium foil (GW-A)

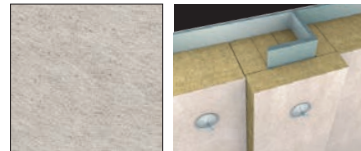

Glass tissue neutral (TN)

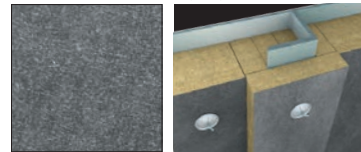

Glass tissue black (TB)

As ROCKWOOL has no control over insulation design and workmanship, accessory materials or applications conditions, ROCKWOOL does not warranty the performance or result of any installation containing ROCKWOOL products. ROCKWOOL's overall liability and the remedies available are limited by the general terms and conditions of sale. This warranty in lieu of all other warranties and conditions expressed or implied, including the warranties of merchantability and fitness for a particular purpose. ROCKWOOL Technical Insulation reserves the right to make necessary product changes at any time. Technical specifications are thus stated subject to change.

ROCKWOOL® Technical Insulation, ROCKWOOL®, SeaRox® and ProRox® are registered trademarks of ROCKWOOL A/S and cannot be used without a prior written consent.